

FLOOR PLAN—GROUND LEVEL

BUILDING AREA
 GROUND LEVEL - 44,296 S.F.
 UPPER LEVEL - 6,375 S.F.
 TOTAL GROSS AREA: 50,671 S.F.

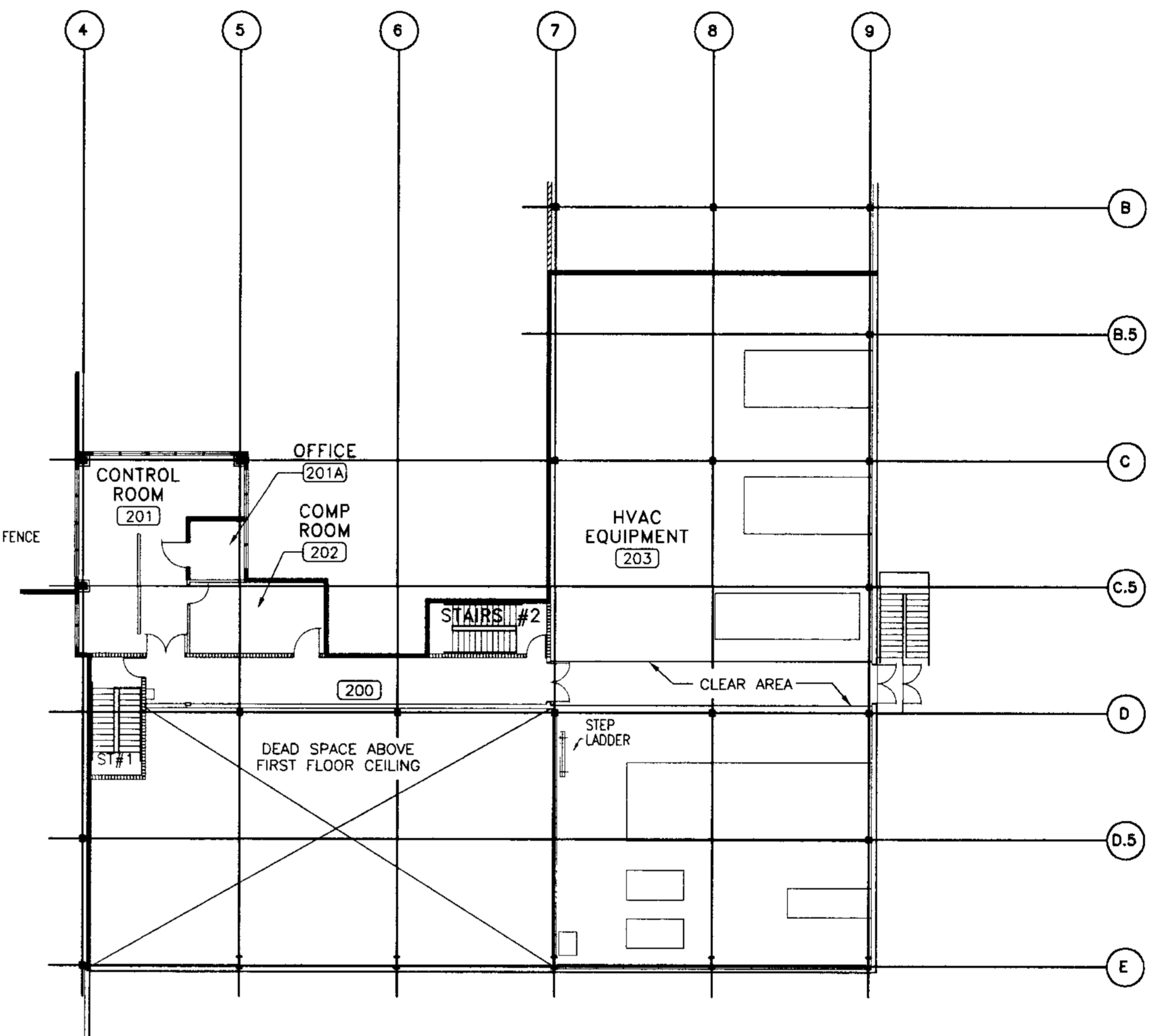

FLOOR PLAN—UPPER LEVEL

LEGEND

— 2 HOUR FIRE WALL
 THE 2 HOUR OCCUPANCY SEPARATION WALLS INDICATED ARE FOR LOSS LIMITATION PURPOSES AND ARE NOT A REQUIREMENT OF THE UBC, UFC OR NFPA.

— 1 HOUR FIRE WALL

APPLICABLE CODES:
 -UNIFORM BUILDING CODE (UBC), 1991 EDITION
 -NATIONAL FIRE PROTECTION ASSOCIATION (NFPA 101) LIFE SAFETY CODE

OCCUPANCY:
 UBC CLASSIFICATION: PROCESS AREAS: H-7
 OFFICE/CHANGE AREAS: B-2
 LUNCH/CONFERENCE ROOM: A-3
 NFPA CLASSIFICATION: GENERAL INDUSTRIAL

CONSTRUCTION TYPE:
 UBC II-N

BUILDING SHALL BE FULLY FIRE PROTECTED BY AN AUTOMATIC SPRINKLER SYSTEM

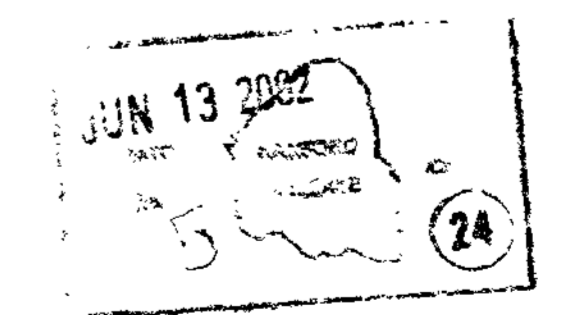
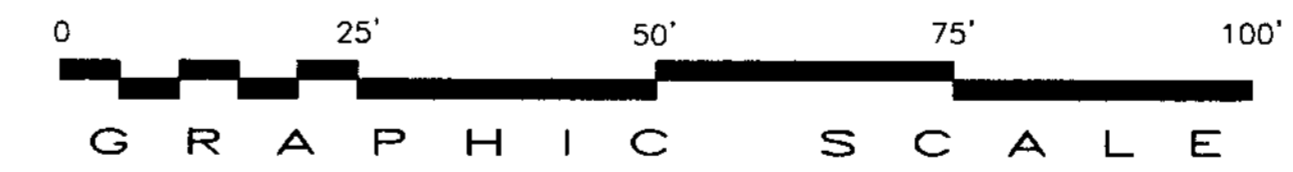

NAME		DATE	COMPANY
W. ROWEN		8-1-93	FTS
L. ROBINSON		8-1-93	FTS
E.A. PLASTINO		8-10-93	FTS
S.A. MAYANCSIK		8-2-93	PH
J.G. RIDDELLE		8-10-93	PH

U.S. DEPARTMENT OF ENERGY
 Richland Operations Office

**WRAP
 GENERAL ARRANGEMENT**

SIZE	BUILD NO	INDEX NO	DWG NO
F	2336W	0804	H-2-818276

SCALE 1/16"=1'-0" ETD 151734 SHEET 1 OF 1

DWG NO	TITLE	REF NUMBER	TITLE

REV NO	DESCRIPTION	REV BY	DATE	CHK BY	DATE	APP'D	COMPANY
3	FV TO CONFIDENCE LEVEL C INCORP HNF-FMP-01-91.36-RD	REM	5/02	6840	6/6/02	[Signature]	FTS

DWG NO H-2-818276 REV 3